

## Service Guidelines

### LEVEL ONE MEMORY ENHANCEMENT:

- Three meals served daily in the Dining Room; menus change daily to ensure exceptional variety
- Nutritional needs monitored to ensure well balanced diet and specialized diets available as needed
- Healthy snacks and beverages available throughout the day
- Weekly housekeeping service
- Laundering of resident-provided sheets and towels
- Weekly personal laundry service
- Daily light tidying, including garbage disposal and bed-making
- Resident-focused therapeutic activity program based upon interests and abilities
- Specialized staff with focused training in serving the unique needs of people who have memory impairment
- Supportive and comfortable setting with cozy common living area and protected sensory garden
- Secured environment
- Frequent safety checks 24-hours-a-day
- Functional assessment completed for initial needs and for developing an ongoing care and service plan

- Quarterly assessments completed to evaluate needs
- Scheduled transportation for programs and events
- Daily minimal assistance with dressing and grooming
- Assistance with bathing (up to twice weekly)
- Medication administration by licensed nurse
- Escorts available within Prairieview
- Licensed Nurses and Certified Nursing Assistants

### LEVEL TWO MEMORY ENHANCEMENT *in addition to components in Level One:*

- More frequent assistance with bathing (up to daily)
- Daily hands-on assistance with dressing and grooming
- Daily hands-on assistance with transfers and/or ambulation
- Incontinence management



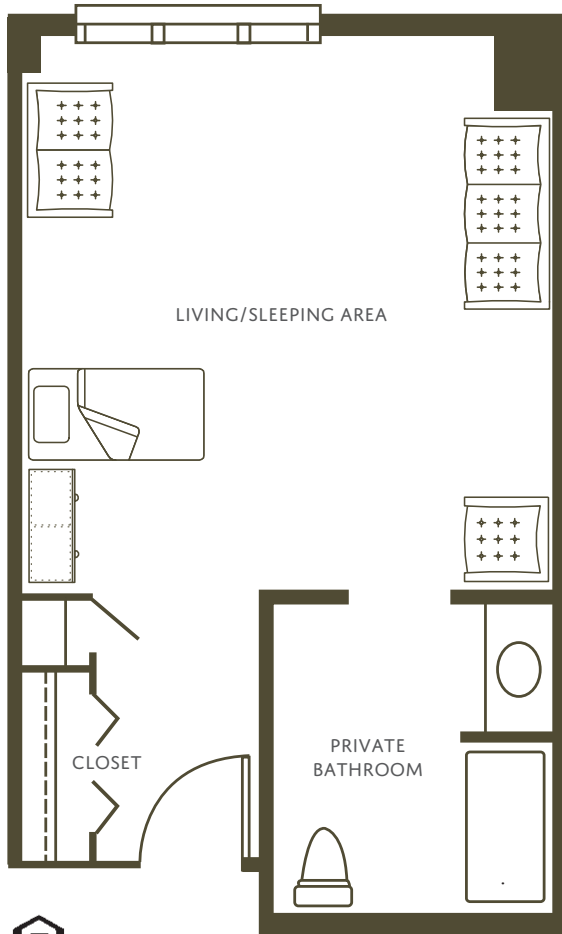

## THE HONEYSUCKLE STUDIO

### *Features of each private residence:*

- Private bathroom featuring easy-access showers with assist bars and bench
- Individually controlled heat and air conditioning
- Ample closet space
- Emergency response system in bedroom and bathroom
- Smoke detectors and sprinklers
- Wall-to-wall carpet and window treatments
- High-quality fixtures, cabinetry and finishes
- Monitored, alarmed fire and security system
- Television, basic cable, telephone pre-wiring

*All dimensions are approximate. Floor plans may vary based on location.*



PRAIRIEVIEW  
— at The Garlands —